

4T60E(M13), 4T65E(MN3, M15, MN7 H.D., M76)

ELECTRONIC 4 SPEED - FWD

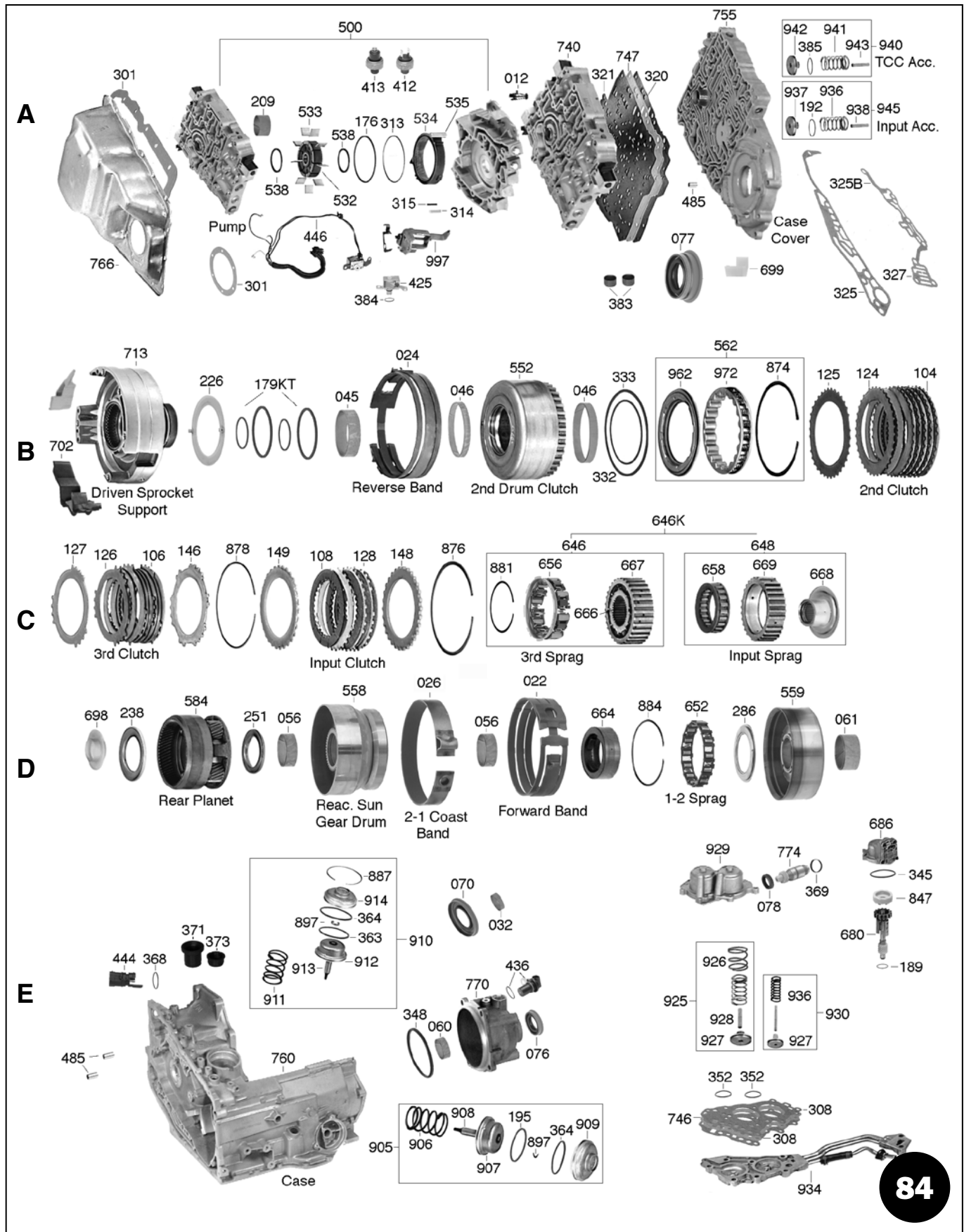

ELECTRONIC 4 SPEED - FWD

4T60E(M13), 4T65E(MN3, M15, MN7 H.D., M76)

4T60E, 4T65E

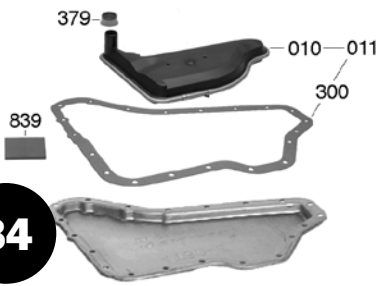
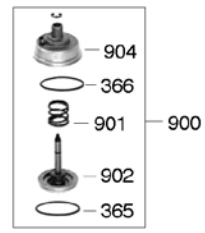
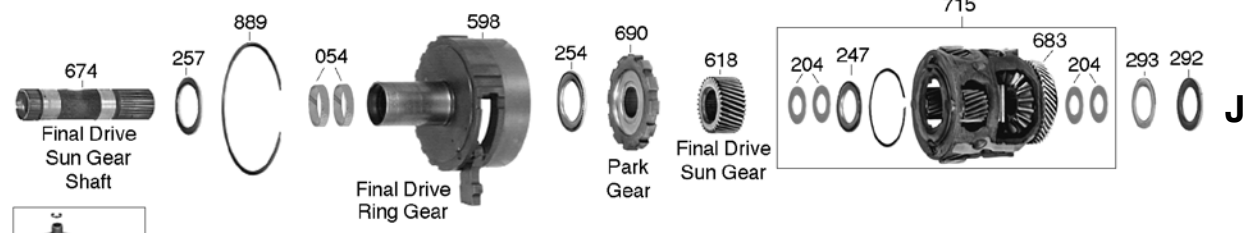
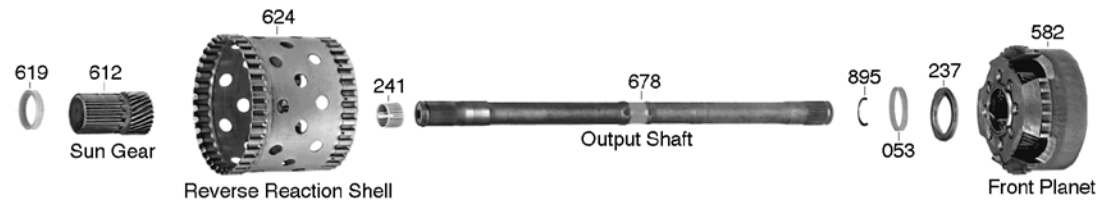
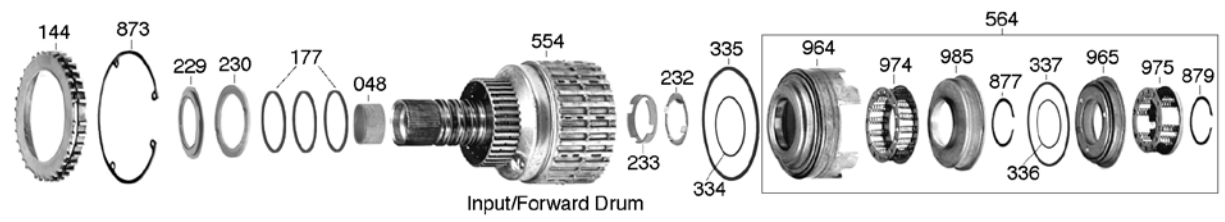
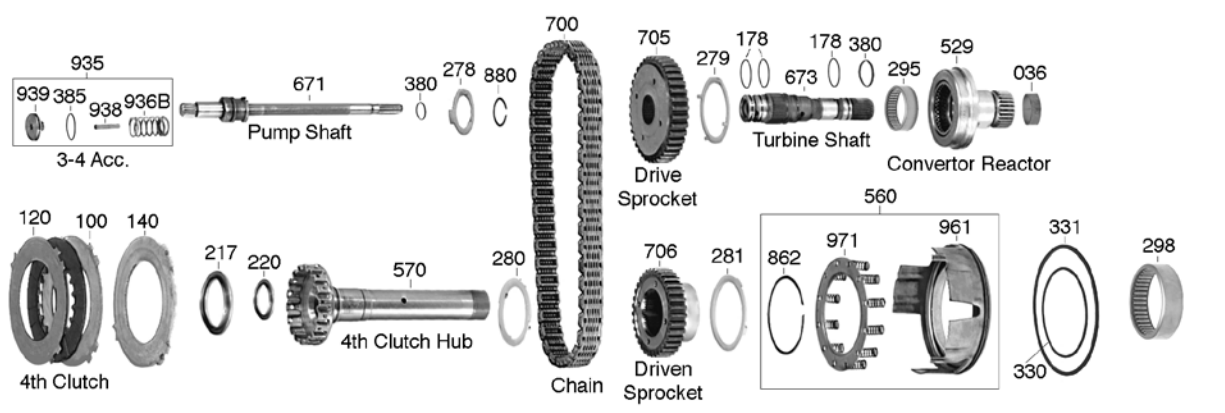

Deluxe Kit	008
Compliance Kit	007
Master Kit	006
Less Steel Kit	004
Overhaul Kit	002
Bushing Kit	030
Washer Kit	200
Bearing Kit	201
Technical Manual	400
Pump Part	507
Valve Body Parts	741
Case Parts	761

Note: Not all items are available for all transmissions

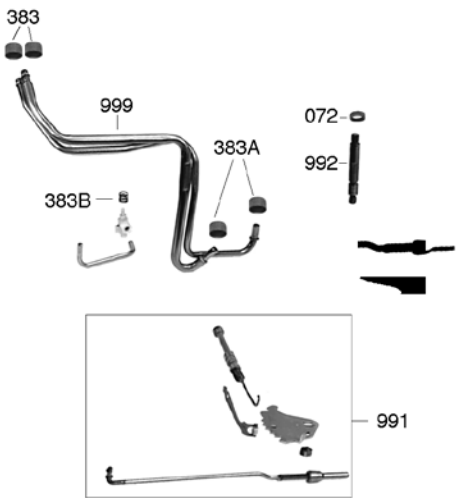

4T60E(M13), 4T65E(MN3, M15, MN7 H.D., M76)

ELECTRONIC 4 SPEED - FWD

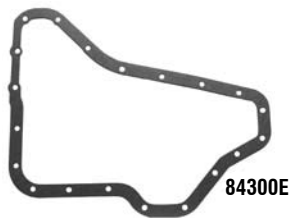

84300E

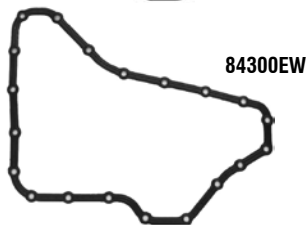

84300EW

BUICK	OLDSMOBILE
CenturyA	Ciera.....A
Electra, Park Avenue....C	Cutlass CruiserA
LeSabreH	Cutlass Supreme
Park Avenue.....Ultra	Delta 88H
ReattaZ	98 RegencyC
RegalG	RoyaleH
RivieraE	Silhouette.....U
Skylark, SomersetN	ToronadoE
	Trofeo
CADILLAC	PONTIAC
AllenteC	6000.....A
Brougham, DeVille.....C	Bonneville.....H
ElDorado.....E	Grand Prix.....G&W
FleetwoodC	Transport.....U
Seville.....K	
CHEVROLET	VOLVO
Beretta,Celebrity,Corsica	99-Up.....
Lumina Z-34A	



84010E

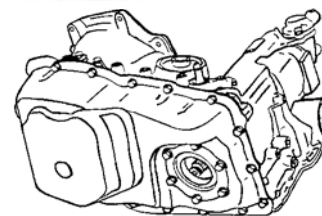

4T60E CASE

ILL.	DESCRIPTION	QTY.	YEAR	PART NO.	REFERENCE NO.
DELUXE KITS (SUPER KITS) (1) (2) (3)					
008K	4T60E (w/o Pistons)	1	91-E94	84008EW	N/A
008K	4T60E (w/o Pistons)	1	L94-99	84008EAW	K6600F-R
008K	4T60E (w/ Pistons) Combo	1	91-99	84008EBPW	K6600E-R
008K	4T65E (w/ Pistons) (also 2003 w/ Sprag Type Input Clutch) (Exc Volvo)	1	97-03	84008GPW	K6600H-R
008K	4T65E (w/ Pistons) (also 2003 w/ Pawl Type Input Clutch) (Exc Volvo)	1	03-Up	84008HPW	N/A
COMPLIANCE KITS (CALIFORNIA KITS) (1) (2) (3)					
007K	4T60E (w/o Pistons)	1	91-E94	84007EW	N/A
007K	4T60E (w/o Pistons)	1	L94-99	84007EAW	CK6600F-R
007K	4T60E (w/ Pistons) Combo	1	91-99	84007EBPW	CK6600E-R
007K	4T65E (w/ Pistons) (also 2003 w/ Sprag Type Input Clutch) (Exc Volvo)	1	97-03	84007GPW	CK6600H-R
007K	4T65E (w/ Pistons) (also 2003 w/ Pawl Type Input Clutch) (Exc Volvo)	1	03-Up	84007HPW	N/A
MASTER OVERHAUL KITS (WITH STEELS) (1) (2) (3)					
006K	4T60E (w/o Pistons)	1	91-E94	84006EW	K6600E
006K	4T60E (w/o Pistons)	1	L94-99	84006EAW	K6600F
006K	4T60E (w/ Pistons) Combo	1	91-99	84006EBPW	K6600E
006K	4T65E (w/ Pistons) (also 2003 w/ Sprag Type Input Clutch) (Exc Volvo)	1	97-03	84006GPW	K6600H
006K	4T65E (w/ Pistons) (also 2003 w/ Pawl Type Input Clutch) (Exc Volvo)	1	03-Up	84006HPW	K6600J
006K	4T65E (w/ Pistons) (Volvo)	1	99-02	84006GAPW	K6600V
LESS STEEL KITS (1) (2) (3)					
004K	4T60E (w/o Pistons)	1	91-E94	84004EW	K6600E-LS
004K	4T60E (w/o Pistons)	1	L94-99	84004EAW	K6600F-LS
004K	4T60E (w/ Pistons) Combo	1	91-99	84004EBPW	K6600E-LS
004K	4T65E (w/ Pistons) (also 2003 w/ Sprag Type Input Clutch) (Exc Volvo)	1	97-03	84004GPW	K6600H-LS
004K	4T65E (w/ Pistons) (also 2003 w/ Pawl Type Input Clutch) (Exc Volvo)	1	03-Up	84004HPW	K6600J-LS
004K	4T65E (w/ Pistons) (Volvo)	1	99-02	84004GAPW	K6600V-LS
OVERHAUL KITS (W/ RINGS & SEALS) (1) (2) (3)					
002K	4T60E (w/o Pistons)	1	91-99	84002EW	K66900E
002K	4T65E (w/o Pistons)	1	99-Up	84002GW	K66900H
GASKET & SEAL KITS (W/O RINGS & SEALS) (1) (2) (3)					
000K	4T60E (w/o Pistons)	1	91-99	84000EW	K66900E-1
000K	4T65E (w/o Pistons)	1	99-Up	84000GW	K66900H-1
	<p>(1) - "W" suffix kits incl. Bonded pan gasket. To order Kits with Fiber pan gaskets, use an "F" suffix</p> <p>(2) - Bonded Side Cover Gasket not included in kits.</p> <p>(3) - For 4T65E Volvo, order GAPW kit or GPW kit plus subkit # 84001G</p>				

ELECTRONIC 4 SPEED - FWD

4T60E(M13), 4T65E(MN3, M15, MN7 H.D., M76)

ILL.	DESCRIPTION	QTY.	YEAR	PART NO.	REFERENCE NO.
FILTER KITS					
011K	Filter Kit, 4T60E (Bonded Pan Gasket)	1	91-99	84011EW	N/A
011K	Filter Kit, 4T60E (Fiber Pan Gasket).....	1	91-99	84011E	FFK66710F
FILTERS					
010K	Filter	1	91-Up	84010E	66710F
012A	Screen, Oil Pump (w/ Tab).....	1	91-Up	84012	66712
012A	Screen, Oil Pump (No Tab).....	1	91-Up	84012A	66712A
016	Screen, Shift Solenoid.....	3-4	91-Up	84016E	66714F
016	Screen, TCC Orifice.....	1	91-Up	84016PA	66714
017	Screen, Servo	1	91-Up	84017A	66714E
BANDS					
Prefix Key: B = Borg Warner, A = OEM (Exc BW), N = All Other New, R = Relined					
022D	Forward (Rear).....	1	91-Up	84022E	66700E
022D	Forward (Rear) (Hi-Energy)	1	01-Up	84022G	66700EH
024B	Reverse (Front)	1	91-Up	84024A	66720E
024B	Reverse (Front) (Hi-Energy).....	1	01-Up	84024G	66720EH
026D	2-1 Coast (Center)	1	91-Up	84026A	66705
026D	2-1 Coast (Center) (Hi-Energy).....	1	91-Up	84026G	66705H
BUSHINGS					
030K	Bushing Kit, 4T60E	1	91-99	84030E	K66901E
030K	Bushing Kit, 4T65E	1	97-Up	84030G	K66901F
032E	Converter Hub.....	1	91-Up	64032B	51005A
036F	Stator Support Front.....	1	91-Up	54036A	32006
045B	Driven Sprocket Support	1	91-Up	84045	66010
046B	2nd Clutch Housing (Rear)	1	91-Up	84046	66012
046B	2nd Clutch Housing (Front)	1	91-Up	84046B	66011
048H	Input Drum (w/ Oil Grooves).....	1	91-Up	84048A	66013
053I	Front Planet (4T60E Only)	1	91-99	84053	66015
054J	Final Drive Internal Gear Shaft.....	2	91-Up	84054	66017
056D	Rear Sun Gear (Forward Band Drum) (Wide Front Bushing)	1	91-Up	84056AA	66016A
056D	Rear Sun Gear (Forward Band Drum) (Narrow Rear Bushing).....	1	91-Up	84056AB	66016B
060E	Bushing, Case.....	2-3	91-Up	64060	51013
061D	2-1 Coast Drum (11/16" Wide) (Center Band Drum).....	1	91-95	84056AA	66016A
061D	2-1 Coast Drum (1 1/4" Wide) (Center Band Drum).....	1	96-Up	84061B	66016C
090	Channel Plate Repair Plate, Elim. Oil Leakage.....	1	91-99	84090	66996P
METAL CLAD SEALS					
070E	Front.....	1	91-Up	84070	51200AV
072K	Manual Lever	1	91-Up	84072A	51202A
075	Seal, Axle Stabilizer (Teckpak)	1	91-99	T84075	51731BS
076E	Axle (Right Side Only) (Exc 4T65E Volvo)	1	91-Up	84076	51201
076E	Axle (Right Side) (4T65E Volvo)	1	97-Up	84076GA	66220D
077A	Axle (Left Side Only) (4T60E).....	1	91-99	84077	66220A
077A	Axle (Left Side Only) (4T65E).....	1	97-Up	84077G	66220C
FRICTION PLATES					
100G	4th Clutch (18 T) (4T60E)	2	91-99	84100A	66104A
100G	4th Clutch (32 T) (4T65E)	2	97-Up	84100G	66104E
100G	4th Clutch (32 T) (4T65E) (Hi-Performance).....	2	97-Up	84100GHP	66104EX
100G	4th Clutch (1 Sided, Internal T) (4T65E) Volvo & 05-Up GM.....	2	99-Up	84100GA	66104H
120G	4th Clutch (1 Sided, External T) (4T65E) Volvo & 05-Up GM	2	99-Up	84120GA	66104J

4T60E, 4T65E

4T60E(M13), 4T65E(MN3, M15, MN7 H.D., M76)

ELECTRONIC 4 SPEED - FWD

ILL.	DESCRIPTION	QTY.	YEAR	PART NO.	REFERENCE NO.
FRICITION PLATES (Cont.)					
104B	2nd Clutch (38 T) (4T60E)	5-6	91-99	84104A	66102A
104B	2nd Clutch (38 T) (4T60E) (Hi-Energy)	5-6	91-99	84104AH	66102AH
104B	2nd Clutch (42 T) (4T65E)	6	97-Up	84104G	66102E
104B	2nd Clutch (42 T) (4T65E) (Hi-Performance)	6	97-Up	84104GHP	66102EX
106C	3rd Clutch (.082") (1 Sided, 32 Internal T)	5	91-Up	84106B	66103C
106C	3rd Clutch (.082") (1 Sided, 32 Internal T) (Hi-Performance)	5	91-Up	84106BHP	66103CX
106C	3rd Clutch (.082") (1 Sided, 32 Internal T) (Hi-Energy)	5	01-Up	84106C	66103H
126C	3rd Clutch (.078") (1 Sided, 12 External T)	5	91-Up	84126AB	66103D
126C	3rd Clutch (.078") (1 Sided, 12 External T) (Hi-Performance)	5	91-Up	84126ABHP	66103DX
126C	3rd Clutch (.078") (1 Sided, 12 External T) (Hi-Energy)	5	01-Up	84126C	66103J
108C	Input Clutch (.090") (32 T)	4	91-E94	84108	66106
108C	Input Clutch (.065") (32 T)	4	L94-Up	84108A	66106A
108C	Input Clutch (.065") (32 T) (Hi-Performance)	4	L94-Up	84108AHP	66106AX
108C	Input Clutch (30 T) (Used w/ Pawl Type Sprag)	4	03-Up	84108B	66106B
108C	Input Clutch (30 T) (Used w/ Pawl Type Sprag) (Hi-Performance)	4	03-Up	84108BHP	66106BX
STEEL PLATES					
120G	4th Clutch (.074") (5 T) (4T60E)	2	91-99	84120B	N/A
120G	4th Clutch (.077") (5 T) (4T60E)	2	91-99	84120	66204
120G	4th Clutch (.083") (3 T) (4T65E)	2	97-Up	84120G	66204E
124B	2nd Clutch (.077") (34 T) (4T60E)	6	91-99	84124A	66202E
124B	2nd Clutch (.077") (34 T) (4T60E) (Kolene)	6	91-99	84124D	66202D
125B	2nd Clutch (.044") (34 T) (4T60E) (Waved)	1	91-99	84125	66202B
124B	2nd Clutch (.068") (36 T) (4T65E)	5	97-Up	84124G	66202G
124B	2nd Clutch (.090") (36 T) (4T65E)	AR	97-Up	84124GA	66202H
125B	2nd Clutch (.065") (36 T) (4T65E) (Waved)	1	97-Up	84125G	66202F
126C	3rd Clutch (.090") (4T60E)	1	91-99	84126	66203
127C	3rd Clutch (.030") (4T60E) (Waved)	1	91-99	84127	66203B
128C	Input Clutch (.076")	3-4	91-Up	64128	51100
128C	Input Clutch (.050")	4	91-Up	84128	66100
129	Input Clutch (.040") (Waved)	1	91-Up	64129	51105
FRICITION & STEEL KITS					
N.I.	Friction & Steel Kit, 4th Clutch .070" (Bent Tooth) (2 Fri. & 2 Thin Steels)	1	91-92	A84100BPK	K66104BX
N.I.	Friction & Steel Kit, 4th Clutch .070" (Bent Tooth) (2 Fri, 2 Thin & 1 Thick Steel)	1	93-99	A84100BAPK	K66104CX
N.I.	Friction & Steel Kit, 2nd Clutch .060" (Power Pack) (7 Fri, 6 Thin & 1 Thick Steel)	1	91-99	A84104CPK	N/A
N.I.	3rd Clutch Z Pack	1	91-Up	84106K	K66103Z
N.I.	Update Kit, 2nd Clutch	1	91-Up	84100AAK	K66-66
N.I.	Clearance Pack, Forward, 2nd, 3rd Clutch	1	91-Up	84119K	K66-66F
N.I.	Steel Module (4T60E)	1	91-E94	84139E	N/A
N.I.	Steel Module (4T60E)	1	L94-99	84139EA	N/A
N.I.	Steel Module (4T60E)	1	91-99	84139EB	N/A
N.I.	Steel Module (4T65E)	1	97-Up	84139G	N/A
PRESSURE PLATES					
Prefix Key: D = OEM, A = Aftermarket New, R = Remanufactured					
140G	4th Clutch (.160") (4T60E)	1	91-92	84140A	66210J
140G	4th Clutch (.135") (4T60E)	2-3	93-99	84140B	66204A
140G	4th Clutch (.128") (4T65E)	1	97-Up	84140G	66210M
144H	2nd Clutch Backing (Beveled) (.125") (4T60E)	1	91-99	84144C	66210D
144H	2nd Clutch Backing (Beveled) (.390") (4T60E)	1	91-99	84144D	66210K
144H	2nd Clutch (.227") (4T65E)	1	97-Up	84144E	66210N
145	2nd Clutch Apply (Flat) (Bottom) (.135") (4T60E)	1	91-99	84145A	66210L
145	2nd Clutch Apply Plate (.130") (4T60E)	1	91-99	84146B	N/A
145	2nd Clutch Apply (.152") (4T65E)	1	97-Up	84148C	66210P
146C	3rd Clutch Backing (.150")	1	91-Up	84146A	66210H

ELECTRONIC 4 SPEED - FWD

4T60E(M13), 4T65E(MN3, M15, MN7 H.D., M76)

ILL.	DESCRIPTION	QTY.	YEAR	PART NO.	REFERENCE NO.
PRESSURE PLATES (Cont.)					
148C	Input Clutch Backing (.190") (Top).....	1	91-Up	84148	51714
149C	Input Clutch Apply (.190") (Bottom).....	1	91-Up	84149	66206
MODULATORS					
160E	Black & Red Stripe (Single Line) Diesel.....	1	91-99	84160B	66820Y
160E	Red Stripe (Dual Line) (GM Universal)	1	91-99	84160R	66820X
160E	Modulator Kit (w/ Large Can Modulator, Valve, & Gaskets).....	1	91-99	84160K	DK66820B
163E	Valve, Modulator	1	91-99	84163A	66821A
VALVE BODY RECALIBRATION KITS					
165K	Lube Kit, Lube & End Play Kit (4T60E) (Transgo®).....	1	91-99	T84165LE	K66908L
165K	Valve Body Kit, Shift Correction Package (4T65E) (Superior).....	1	97-Up	S84165G	66C04
165K	Shift Kit-Jr®, Junior (4T60E) (Transgo®).....	1	91-99	T84167E	K66908E
165K	Shift Kit® (4T65E) (Transgo®)	1	97-04	T84167G	K66908G
165K	Sure Cure Kit (4T60E) (requires T-84754-TL5) (Sonnax).....	1	93-96	S84174	66S02
165K	Sure Cure Kit (4T60E) (requires T-84754-TL5 & DJ2) (Sonnax)	1	97-99	S84174A	66S03
165K	Sure Cure Kit (4T65E) (requires T-84754-TL3, T-F-84596-TL, T-VB-FIX) (Sonnax)	1	97-Up	S84174G	66S05
SEALING RINGS					
175K	Ring Kit (4T60E)	1	91-99	84175E	N/A
175K	Ring Kit (4T65E)	1	97-Up	84175G	K66300BT
175K	Ring Kit (2 Vespel Rings & 2 Rubber Expanders)	1	91-99	84179KT	N/A
177H	Input Shaft (Solid)	1	91-99	64178AT	51310T
178F	Turbine Shaft (Front) (Solid)	1	91-Up	64178AT	51310T
178F	Turbine Shaft (Rear) (Solid)	2	91-Up	64178BT	51307T
179B	2nd Clutch (4T60E).....	2	91-99	84179BT	N/A
179B	2nd Clutch (4T65E) (.125" Wide Plastic)	2	97-E98	84179T	N/A
179B	2nd Clutch (4T65E) (.100" Wide Plastic)	2	L98-Up	84179AT	N/A
192A	Input Clutch Accumulator	1	91-Up	84192T	N/A
195E	1-2 Reverse Servo	1	91-Up	84195T	N/A
THRUST WASHERS					
200K	Washer Kit (4T60E) (No Selectives).....	1	91-99	84200	K66400
200K	Washer Kit (4T60E) (w/ Popular Selectives).....	1	91-99	84200B	N/A
200K	Washer Kit (4T65E).....	1	97-Up	84200G	K66400E
226B	Driven Sprocket Support to 2nd Clutch Drum (4T60E).....	1	91-99	84226	66412
226B	Driven Sprocket Support to 2nd Clutch Drum (4T65E).....	1	97-Up	84226G	66412A
230H	Input Drum 2.90-3.00mm (Orange-Green).....	1	91-Up	84230	66415A
230H	Input Drum 3.05-3.15mm (Orange-Black)	1	91-Up	84230A	66415B
230H	Input Drum 3.20-3.30mm (Orange).....	1	91-Up	84230B	66415C
230H	Input Drum 3.35-3.45mm (White)	1	91-Up	84230C	66415D
230H	Input Drum 3.50-3.60mm (Blue)	1	91-Up	84230D	66415E
230H	Input Drum 3.65-3.75mm (Pink)	1	91-Up	84230E	66415F
230H	Input Drum 3.80-3.90mm (Brown).....	1	91-Up	84230EA	66415G
230H	Input Drum 3.95-4.05mm (Green).....	1	91-Up	84230G	66415H
230H	Input Drum 4.10-4.20mm (Black)	1	91-Up	84230H	66415J
230H	Input Drum 4.25-4.35mm (Purple).....	1	91-Up	84230HA	66415K
230H	Input Drum 4.40-4.50mm (Purple-White)	1	91-Up	84230J	66415L
263	4th Hub to Case Cover (3 Tabs) (Teflon Coated) (4T65E).....	1	97-Up	84263G	66421
278F	Drive Sprocket to Channel Plate (4T60E)	1	91-99	84278	66411
278F	Drive Sprocket to Channel Plate (4T65E)	1	97-Up	84278G	66411A
279F	Drive Sprocket to Support (4T60E).....	1	91-99	84279A	51413
279F	Drive Sprocket to Support (3 Round Solid Tabs) (4T65E).....	1	97-00	84279G	66420
279F	Drive Sprocket to Support (3 Split Locking Tabs) (4T65E).....	1	01-Up	84279H	66420A

4T60E, 4T65E

4T60E(M13), 4T65E(MN3, M15, MN7 H.D., M76)

ELECTRONIC 4 SPEED - FWD

ILL.	DESCRIPTION	QTY.	YEAR	PART NO.	REFERENCE NO.
THRUST WASHERS (Cont.)					
280G	4th Clutch Hub to Driven Sprocket (4T60E).....	1	91-99	84280	66414
280G	4th Clutch Hub to Driven Sprocket (4T65E).....	1	97-Up	84280G	66414A
281G	Driven Sprocket to Support (4 Legs) (4T60E).....	1	91-99	84281	66410
281G	Driven Sprocket to Support (3 Legs) (4T65E).....	1	97-Up	84281G	66410A
N.I.	Repair Kit, Final Drive Planet (16 Steel Washers) (Small).....	1	91-Up	64204C	K51440
N.I.	Repair Kit, Final Drive Planet (16 Steel Washers) (.850" OD, .440" ID).....	1	91-Up	84204B	N/A
N.I.	Repair Kit, Final Drive Planet (8 Brass & 8 Steel Washers) Early.....	1	91-Up	64204D	K51440A
BEARINGS					
201K	Bearing Kit.....	1	91-Up	84201A	K66500
209	Bearing, Pump Shaft.....	1	91-99	84209	66520
217G	Bearing, 4th Clutch Hub to Channel Plate.....	1	91-99	84217	66508
220G	Bearing, 4th Clutch Hub.....	1	91-99	84220A	66952
229H	Bearing, 2nd Clutch Drum to Input Drum.....	1	91-Up	84229	66504
232H	Bearing, Input Drum Rear.....	1	91-Up	84232A	66413A
238D	Bearing, Front Planet to Rear Planet.....	1	91-Up	84238	66502
241I	Bearing, Sun Gear (Split, Inner) (3/4" Long).....	1	91-6/93	84241A	66521A
247J	Bearing, Sun Gear to Differential Carrier (2.00" OD).....	1	91-Up	54247A	32409A
247J	Bearing, Sun Gear to Differential Carrier (2.125" OD).....	1	91-Up	84247	51454
247J	Bearing, Sun Gear to Differential Carrier (2.250" OD).....	1	91-Up	84247A	66514
251D	Bearing, Rear Planet to Sun Gear Drum.....	1	91-Up	84251	66501
254J	Bearing, Internal Gear to Part Gear.....	1	91-95	84254	66506
254J	Bearing, Internal Gear to Part Gear.....	1	96-Up	84254A	66506A
257J	Bearing, Reaction Drum to Internal Ring Gear.....	1	91-Up	84257	66509
257J	Race, Reaction Drum to Internal Ring Gear .140".....	1	91-Up	84257B	66417
275	Axle Stabilizer, Passenger Side (w/ Bearing & Seal).....	1	91-Up	T64275	51731B
275	Axle Stabilizer, Driver Side (w/ Bearing & Seal).....	1	91-99	T84275	66731B
286D	Bearing, 1-2 Sprag to Forward Band Drum.....	1	91-95	54242AA	32408A
286D	Bearing, 1-2 Sprag to Forward Band Drum.....	1	96-Up	84286C	66507
242	Bearing, Between 1-2 Roller Housing & Race.....	1	91-99	54242AA	32408A
292J	Bearing, Differential to Case.....	1	91-Up	64292	51461
295F	Needle Bearing, Converter Reactor (Presses Inside).....	1	91-Up	64295	51486
298G	Needle Bearing, Driven Sprocket Support (Presses Inside).....	1	91-Up	84298	66954
SHIMS & SPACERS					
230H	Shim Kit (.010") (10 Per Kit).....	1	91-Up	84230S	66415S
230H	Shim Kit (.020") (10 Per Kit).....	1	91-Up	84230SA	66415T
233H	Sleeve, Input Drum Rear (4 Notches).....	1	91-Up	84741C-2	66932
257J	Race, Reaction Drum to Internal Ring Gear .140".....	1	91-Up	84257B	66417
293J	Spacer, Differential to Case 1.65mm (#2).....	1	91-Up	64293B	51417A
293J	Spacer, Differential to Case 1.75mm (#3).....	1	91-Up	64293C	51417B
293J	Spacer, Differential to Case 1.85mm (#4).....	1	91-Up	64293D	51417C
293J	Spacer, Differential to Case 1.95mm (#5).....	1	91-Up	64293E	51417D
293J	Spacer, Differential to Case 2.05mm (#6).....	1	91-Up	64293F	51417E
293J	Spacer, Differential to Case 2.15mm (#7).....	1	91-Up	64293G	51417F
293J	Spacer, Differential to Case 2.25mm (#8).....	1	91-Up	64293H	51417H
293J	Spacer, Differential to Case 2.35mm (#9).....	1	91-Up	64293J	51417J
293J	Shim, Differential Carrier to Case.....	1	91-Up	84293S	51417S
GASKETS & O-RINGS					
300K	Bottom Pan (Cork) (4T60E).....	1	91-99	84300E	13966AR
300K	Bottom Pan (Fiber) (4T60E).....	1	91-99	84300EF	13966AF
300K	Bottom Pan (Bonded) (8mm Pan Bolts).....	1	91-Up	84300EW	13966AR
300K	Bottom Pan (Bonded) (6mm Pan Bolts).....	1	L98-Up	84300EAW	13966BR

ELECTRONIC 4 SPEED - FWD

4T60E(M13), 4T65E(MN3, M15, MN7 H.D., M76)

ILL.	DESCRIPTION	QTY.	YEAR	PART NO.	REFERENCE NO.
GASKETS & O-RINGS (Cont.)					
301A	Side Cover (Outer) (4T60E) (Cork)	1	91-93	84301	13450
301A	Side Cover (Outer) (4T60E) (Fiber)	1	91-93	84301F	13450F
301A	Side Cover (Outer) (4T60E) (Bonded)	1	94-99	84301E	13450R
301A	Side Cover (Outer) (4T65E) (Bonded)	1	97-Up	84301GW	13453R
301A	Side Cover (Inner) (4T60E)	1	91-93	84301J	13451
301A	Side Cover (Inner) (4T60E) (Lathe Cut)	1	94-99	84301LA	13451R
301A	Side Cover (Inner) (4T65E) (Lathe Cut)	1	97-Up	84301GA	13451AR
308E	Gasket, Accumulator Cover (w/ Spacer Plate) (4T60E)	1	91-99	84308A	13452E
308E	Gasket, Accumulator Cover (w/ Spacer Plate) (4T65E)	1	97-Up	84308G	13452F
313A	O-Ring, Pump Slide Back-Up	1	91-Up	84313	13982A
314A	Seal, Pump Slide (Rubber)	1	91-Up	54314B	13768
315A	Seal, Pump Slide (Teflon)	1	91-Up	54315B	13762
320A	Gasket, Valve Body Spacer Plate to Channel Plate (4T60E)	1	91-92	84320B	13788A
320A	Gasket, Valve Body Spacer Plate to Channel Plate (4T60E)	1	93-99	84320BA	13788B
320A	Gasket, Valve Body Spacer Plate to Channel Plate (4T65E)	1	97-Up	84320G	13788E
320A	Gasket, Valve Body Separator Plate (Bonded) (4T65E)	1	99-03	84320K	13787M
320A	Gasket, Valve Body Separator Plate (Bonded) (4T65E)	1	04-Up	84320L	13787N
320A	Gasket Kit, Valve Body (4T65E) (Volvo)	1	97-Up	84320GAK	N/A
321A	Gasket, Valve Body to Spacer Plate (4T60E)	1	91-92	84321B	13787A
321A	Gasket, Valve Body to Spacer Plate (4T60E)	1	93-99	84321BA	13787B
321A	Gasket, Valve Body to Spacer Plate (4T65E)	1	97-Up	84321G	13787E
325A	Gasket, Lower Channel Plate (4T60E)	1	91-99	84325A	13805A
325A	Gasket, Lower Channel Plate (4T65E)	1	97-Up	84324G	13805B
325A	Gasket Kit, Channel Plate (4T60E)	1	91-99	84325AK	N/A
325A	Gasket, Upper Channel Plate (4T60E)	1	91-99	84325E	13806A
325A	Gasket, Upper Channel Plate (4T65E)	1	97-Up	84325G	13806B
348E	Lathe Cut Seal, Extension Housing to Case	1	91-Up	84348	13781
352E	Lathe Cut Seal, 1-2 & 3-4 Accumulator Piston	2	91-Up	54352A	13965
354F	O-Ring, 3-4 Accumulator	1	91-Up	84354A	N/A
360	Seal, 1-2 Servo Cover (4T65E)	1	97-Up	84360	N/A
362	O-Ring, 2-1 Servo Cover to Case .066"	1	91-E95	84362A	N/A
362	O-Ring, 2-1 Servo Cover to Case .132"	1	L95-Up	84362B	N/A
363E	Lip Seal, Reverse Servo Piston	1	91-Up	84363A	N/A
364E	O-Ring, Reverse Servo Cover (4T60E)	1	91-Up	84364	13803
364E	O-Ring, Reverse Servo Cover (4T65E)	1	99-Up	84364C	13803A
364E	O-Ring, Forward Servo Cover	1	91-Up	84364B	N/A
371E	Boot, Filler Tube	1	91-Up	44371B	13925
376	O-Ring, Converter Clutch Solenoid Screen	1	91-Up	84376	13795
379K	Seal, Filter Seal	1	91-Up	84379	13987
380F	O-Ring, Turbine Shaft	1	91-Up	64380	13766
TECHNICAL MANUALS					
400K	Tech Manual (4T60E)	1	91-99	84400E	66Y03
400K	Tech Manual (4T65E)	1	97-Up	84400G	66Y07
400K	Tech Manual (4T65E) Update	1	97-Up	84400J	66Y08
400K	Transmission Guide (GM) (4T60E)	1	91-99	84400EB	N/A
400K	Transmission Guide (GM) (4T65E)	1	97-Up	84400GA	N/A
400K	Tech Video, 4T60E (Includes Manual) (4T60E)	1	91-99	84407E	N/A
ELECTRICAL COMPONENTS					
410	Switch, MLPS (1 Connector w/ 7 Pins, 1 Connector w/ 4 Pins)	1	96-Up	84410HA	N/A
410	Switch, MLPS (1 Connector w/ 6 Pins)	1	99-Up	84410H	15D-329
412A	Switch, Pump TCC Pressure (1 Prong N.O.)	1	91-99	74411B	15A-118
413A	4th Clutch Pressure Switch (1 Prong)	1	91-99	84413A	15D-131A

4T60E, 4T65E

ILL.	DESCRIPTION	QTY.	YEAR	PART NO.	REFERENCE NO.
ELECTRICAL COMPONENTS (Cont.)					
418	Solenoid, TCC PWM.....	1	91-99	84418A	5A-160
418	Solenoid, TCC PWM (Teckpak).....	1	91-99	T84418A	5T-160
420	Solenoid Master Kit (4T60E).....	1	91-99	84420K	N/A
420	Solenoid Master Kit (4T65E).....	1	97-Up	84420AK	N/A
421	Solenoid, 1-2, 3-4 Shift (4T60E).....	2	91-99	84421	5R-144
421	Solenoid, 1-2, 3-4 Shift (4T65E) (Rostra) (D14421A does not fit).....	2	97-Up	14421A	5D-188
421	Solenoid, 1-2, 3-4 Shift (4T65E) (OEM).....	2	97-Up	D84421G	5D-167
425	Solenoid, Lock-up (TCC) (4T60E).....	1	91-99	84421	5R-144
425	Solenoid, Lock-up (TCC) (4T65E) (replaces 84425A).....	1	97-Up	74418E	5B-187
431	Solenoid, EPC (4T65E) (Holley).....	1	97-02	84431G	5A-186
431	Solenoid, EPC (4T65E) (Bosch).....	1	03-Up	84431H	5D-186B
436E	Sensor, Output Speed (VSS) (4T60E).....	1	91-99	84436A	20D-200
436E	Sensor, Output Speed (VSS) (4T65E) (Short Connector 2" Tall).....	1	97-99	84436A	20D-200
436E	Sensor, Output Speed (VSS) (4T65E) (Long Connector).....	1	99-Up	84436G	20A-200A
437	Switch, Temperature.....	1	91-99	84437B	N/A
437	Sensor, Temperature (TOT).....	1	91-99	84437E	N/A
438	Sensor, Input Speed (TSS) (4T65E) (Exc 99-Up Volvo).....	1	97-Up	84438G	20D-210
438	Sensor, Input Speed (TSS) (4T65E) (99-Up Volvo).....	1	99-Up	84438GA	N/A
442	Switch, Manifold (Pressure Range Sensor) (4T65E) 4 Prong.....	1	97-02	84442G	15D-167
442	Switch, Manifold (Pressure Range Sensor) (4T65E) 1 Prong.....	1	03-Up	84442H	15D-167A
444E	Connector (Round 7 Prong Black).....	1	94-99	84444C	25D-112
445	Repair Kit, External Wire Harness.....	1	91-93	84445K	N/A
445	Repair Kit, External Wire Harness.....	1	94-98	84445AK	N/A
446	Repair Kit, Speed Sensor Connector.....	1	91-99	74446CK	35R-216
446A	Wire Harness, Internal (4T60E).....				
	(6 Prong Connector w/ 4 Two Prong Conn.) (w/ PWM).....	1	91-93	84446EA	35R-108A
	(7 Prong Connector w/ 2 One Prong Conn.) (w/o PWM).....	1	91-93	84446E	35R-108
	(All 4T60E 94-99).....	1	94-99	84446EC	35R-108B
446A	Wire Harness, Internal (4T65E).....				
	(Universal replaces 14, 17 & 19 Pin Connectors).....	1	97-Up	84446HB	35R-167
	(14 Pin Connector w/o Internal Mode Switch).....	1	97-Up	84446G	35D-167
	(17 Pin Connector).....	1	03-Up	84446HA	35D-167B
	(19 Pin Connector w/ Internal Mode Switch).....	1	00-Up	84446H	35D-167A
HARD PARTS					
Prefix Key: D = OEM, A = Aftermarket New, R = Remanufactured					
PUMPS					
500A	Pump (No Switches) (4T60E).....	1	91-94	84500E	66990C
500A	Pump (No Switches) (4T60E).....	1	95-99	84500ED	66990D
500A	Pump (2 Switches) (4T60E) No Brass Air Bleed).....	1	91-94	84500EB	N/A
500A	Pump, No Pump Rotor Support (4T65E) (Cast # 24206183).....	1	97-02	84500G	66990F
500A	Pump, w/ Pump Rotor Support (4T65E).....	1	02-Up	84500H	66990E
520A	Pump Cover, 13 Bolt.....	1	91-95	84520	66992B
PUMP COMPONENTS					
507K	Pump Cover Sleeve.....	1	91-01	64541	N/A
529F	Converter Reactor (4T60E).....	1	91-99	84529B	66985A
529F	Converter Reactor (4T65E).....	1	97-Up	84529G	66985C
532A	Rotor, Pump (Vane Style) (95-02).....	1	95-02	84532EA	N/A
532A	Rotor, Pump (Bearing Style) (03-Up).....	1	03-Up	84532G	N/A
532A	Rotor Kit, Pump (Vane Style) (95-02).....	1	95-02	84532EAK	N/A
533A	Vane, Pump (17.952mm).....	9-11	91-Up	84533AA	66800
533A	Vane Kit, Pump (17.952mm) (9 Vanes).....	1	91-Up	84533AAK-1	K66800

ELECTRONIC 4 SPEED - FWD

4T60E(M13), 4T65E(MN3, M15, MN7 H.D., M76)

ILL.	DESCRIPTION	QTY.	YEAR	PART NO.	REFERENCE NO.
PUMP COMPONENTS (Cont.)					
533A	Vane Kit, Pump (17.952mm) (11 Vanes)	1	91-Up	84533ABK-1	K66800B
533A	Vane & Ring Kit, Pump (17.952mm).....	1	91-99	84533AAK	N/A
533A	Vane & Ring Kit, Pump (17.970mm).....	1	91-99	84533ABK	N/A
534A	Slide, Pump 17.968mm	1	91-Up	84534AB	66803
535A	Pin, Pivot Slide (No Groove)	1	91-93	84535	66805
535A	Pin, Pivot Slide (w/ Groove).....	1	93-Up	84535A	66805A
538A	Ring, Pump Vane	2	91-Up	84538	66324
DRUMS & CLUTCH HUBS					
552B	2nd Clutch (4T60E) (6 Clutch) (Used w/ Molded Piston)	1	91-99	84552C	66926B
552B	2nd Clutch (4T65E) (25 Degree Splines)	1	97-Up	84552G	N/A
552B	2nd Clutch (4T65E) (10 Degree Splines) (retros 97-Up if used w/ 84624BA)	1	98-Up	84552GA	66926E
552B	2nd Clutch Housing & Shell (4T65E) (Upgrade) (10 Degree Splines)	1	97-Up	84552GAK	K66926E
554H	Forward w/ Input Shaft (4T60E) (Bearing Type)	1	91-E93	84554BA	66999B
554H	Forward w/ Input Shaft (4T60E) (w/ Caged Bearing Inside)	1	L93-99	84554C	66999C
554H	Forward w/ Input Shaft (4T65E) (w/ Caged Bearing Inside)	1	97-Up	84554G	66999E
558D	Reaction Drum w/ Sun Gear 2 3/4" Tall	1	91-95	84558A	66960A
558D	Reaction Drum w/ Sun Gear 3 1/4" Tall	1	96-Up	84558B	66960B
559D	Forward Band Drum (16 Roller Type Sprag).....	1	91-95	84559	66964
559D	Forward Band Drum (14 Roller Type Sprag).....	1	96-Up	84559B	66964A
570G	4th Clutch Hub & Shaft (Bearing at the Clutch Hub End No Sleeve/Race at Splined End)	1	91-E93	84570	N/A
570G	4th Clutch Hub & Shaft (Bearing at the Clutch Hub End Has Sleeve/Race at Splined End)	1	L93-95	84570A	66956
570G	4th Clutch Hub & Shaft (No Bearing at the Clutch Hub End Has Sleeve/Race at Splined End)	1	96-99	84570B	66956B
570G	4th Clutch Hub & Shaft (32 T) (4T65E).....	1	97-Up	84570G	66956E
PLANETS					
582I	Front (w/ Bushing) (4T60E)	1	91-E93	84582AB	66905A
582I	Front (No Bushing) (4T60E)	1	91-99	84582B	66905B
582I	Front (No Bushing) (4T65E) (12 Outer Lugs)	1	97-Up	84582G	66905C
584D	Rear (Inner Splines Beveled on One End Only)	1	91-Up	84584	N/A
584D	Rear (Inner Splines Beveled Both Ends)	1	91-Up	84584A	66955A
<i>(* Final Drive Ring Gears, see Differential Section</i>					
SUN GEARS, SHELLS & SUPPORTS					
612I	Sun Gear, Input (Front)	1	91-E93	84612	66904
612I	Sun Gear, Input (Front) (w/ 2 Flats on Splines, Bearing Type).....	1	L93-Up	84612A	66904N
612I	Sun Gear, Input (Front) (w/ 2 Flats on Splines, No Bearing)	1	96-Up	84612B	66904B
619I	Spacer, Input Sun Gear .350"	1	91-E93	84619A	66945
619I	Spacer, Input Sun Gear .338"	1	L93-99	84619B	66945A
624I	Shell, Reverse Reaction (4T60E) (Hardened)	1	91-99	84624	66978A
624I	Shell, Reverse Reaction (4T65E) (25 Degree Splines)	1	97-Up	84624B	N/A
624I	Shell, Reverse Reaction (4T65E) (10 Degree Splines) (97-Up use w/ 84552GA)	1	98-Up	84624BA	66978B
<i>(* Final Drive Sun Gears, see Differential Section</i>					
SPRAGS					
646C	Sprag Assembly, 3rd/ Low Input (4T60E)	1	91-E93	84646A	K66939A
646C	Sprag Assembly, 3rd/ Low Input (4T60E)	1	L93-99	84646BK	K66939B
646C	Sprag Assembly, 3rd/ Low Input (4T65E) (1 Piece).....	1	97-02	84646BK	K66939B
646C	Sprag Assembly, 3rd/ Low Input (4T65E) (Mechanical Type)	1	03-Up	84646D	66939D
648C	Sprag Assembly, Input (4T65E) (Mechanical Type)	1	03-Up	84648D	66933D
652D	Sprag, 1-2 Roller (16 Rollers).....	1	91-95	44654	35503H
652D	Sprag, 1-2 Roller (14 Roller, Plastic Cage)	1	96-Up	84652A	66974
652D	Accordion Springs, HD., Prevents 1-2 Roller Clutch Failure (16 Per Kit)	1	91-95	84652A-1	K66903
656C	Roller, 3rd Clutch.....	1	91-E93	84656	66939

4T60E, 4T65E

4T60E(M13), 4T65E(MN3, M15, MN7 H.D., M76)

ELECTRONIC 4 SPEED - FWD

ILL.	DESCRIPTION	QTY.	YEAR	PART NO.	REFERENCE NO.
SPRAGS (Cont.)					
658C	Sprag, Low Input.....	1	91-E93	84658A	66933A
658C	Sprag Set, Low Input & 3rd Clutch Double Sprag	1	L93-95	84658BK	66939S
658C	Sprag Set, Low Input & 3rd Clutch Double Sprag	1	96-Up	84658CK	66939T
664D	Inner Race, 1-2 Roller	1	91-95	84664	66973
667C	Outer Race, 3rd Sprag.....	1	91-E93	84667A	N/A
SHAFTS					
671F	Pump Shaft, Oil Pump Drive (9 3/4" Long) (4T60E).....	1	91-99	84671	66981
671F	Pump Shaft, Oil Pump Drive (10" Long) (4T65E).....	1	97-Up	84671G	66981B
673F	Turbine Shaft (6" Long) (4T60E)	1	91-99	84673A	66930
673F	Turbine Shaft (6 1/4" Long) (4T65E)	1	97-Up	84673G	66930E
674J	Final Drive Sun Gear Shaft (6 1/4" Long)	1	91-Up	84674B	66934A
678I	Output Shaft (17 3/4") (Uses a 3/4" Long # 241 Bearing) (4T60E).....	1	91-E93	84678C	N/A
678I	Output Shaft (19 1/2") (Uses a 3/4" Long # 241 Bearing) (4T60E).....	1	91-E93	84678D	66906B
678I	Output Shaft (19 1/2") (No Bearing Under 4th Clutch Hub) (4T60E)	1	L93-99	84678E	66906D
678I	Output Shaft (19 1/2") (w/ Bearing Under 4th Clutch Hub) (4T60E) Turbo	1	96-99	84678G	66906F
678I	Output Shaft (4T65E)	1	97-Up	84678H	66906J
CHAINS					
700F	Chain (4T60E) (Round Pin 7/8" Wide).....	1	91-93	84700A	51973A
700F	Chain (4T60E) (Exc Round Pins) (Replaces Rocker Joint Pins & D Pins).....	1	93-99	14700B	86973B
700F	Chain (4T65E) (w/ Mouse Ear Link & D Pins) (1/2" Wide) (Dual Chains).....	1	97-Up	84700G	51973E
700F	Chain (4T65E) (Racing) (1" Wide).....	1	97-Up	84700H	51973H
702B	Scoop, Chain Scavenging (2nd Design) (For 33 T Sprocket)	1	91-Up	84702B	N/A
702B	Scoop, Chain Scavenging (2nd Design) (For 35 T Sprocket)	1	91-Up	84702C	N/A
SPROCKETS SETS					
705F	Sprocket Set, w/ Shaft (35 Drive & 35 Driven) (Rocker Pin)	1	93-Up	84710FK	K66977B
705F	Sprocket Set, w/ Shaft (37 Drive & 33 Driven) (Round Pin)	1	91-92	84710CK	K66977A
705F	Sprocket Set, w/ Shaft (37 Drive & 33 Driven) (Rocker Pin)	1	93-Up	84710CAK	K66977C
705F	Chain & Sprocket Set, Gemini Design (33 Drive & 37 Driven) (4T65E)	1	97-Up	84710GAK	K66977J
705F	Chain & Sprocket Set, Gemini Design (35 Drive & 35 Driven) (4T65E)	1	97-Up	84710GK	K66977H
705F	Chain & Sprocket Set, Gemini Design (37 Drive & 33 Driven) (4T65E)	1	97-Up	84710GBK	K66977G
713B	Support, Driven Sprocket (4T60E).....	1	1991	84713B	N/A
713B	Support, Driven Sprocket (4T60E).....	1	92-99	84713C	66949B
713B	Support, Driven Sprocket (1st Design Sealing Ring) (4T65E)	1	97-E98	84713G	66949C
713B	Support, Driven Sprocket (2nd Design Sealing Ring) (4T65E)	1	L98-Up	84713H	66949F
DIFFERENTIAL SECTION					
715J	Final Dr Kit, 2.86/2.84 Ratio (w/ Reluctor) Bushing Type	1	91-95	84715CAK	N/A
715J	Final Dr Kit, 2.86/2.84 Ratio (w/ Reluctor) Bushing Type	1	96-Up	84715CEK	66972L
715J	Final Dr Kit, 3.05/3.06 Ratio (w/ Reluctor) Bushing Type	1	91-95	84715AAK	N/A
715J	Final Dr Kit, 3.05/3.06 Ratio (w/ Reluctor) Bushing Type	1	96-Up	84715AEK	66972M
715J	Final Dr Kit, 3.29/3.33 Ratio (w/ Reluctor) Bushing Type	1	91-95	84715BAK	N/A
715J	Final Dr Kit, 3.29/3.33 Ratio (w/ Reluctor) Bushing Type	1	96-Up	84715BEK	66972N
715J	Final Dr Kit, 3.29/3.33 Ratio (w/ Reluctor) Bearing Type (MN7)	1	96-Up	84715DEK	66972S
715J	Final Dr Kit, 3.05 Only Ratio (w/ Reluctor) Bearing Type (MN7) Fine Pitch, HD Carrier	1	96-Up	84715DGK	66972R
715J	Carrier, 30T Sun Gr, 3.33 Ratio, Std Pitch, 2.945 Journal (w/o Reluctor)	1	91-Up	84715CG	66972K
715J	Carrier, 34T Sun Gr, 3.06 Ratio, Std Pitch, 2.945 Journal (w/o Reluctor)	1	91-Up	84715BB	66972J
715J	Carrier, 38T Sun Gr, 2.84 Ratio, Std Pitch, 2.945 Journal (w/o Reluctor)	1	91-Up	84715AC	66972H
598J	Ring Gear, Final Drive (70 Right Angled Teeth)	1	91-95	84598A	66935A
598J	Ring Gear, Final Drive (70 Right Angled Teeth)	1	96-Up	84598C	66935C
598J	Ring Gear, Final Drive (70 Left Angled Teeth)	1	L93-95	84598B	66935B
598J	Ring Gear, Final Drive (78 Left Angled Teeth)	1	96-99	84598D	66935D

ELECTRONIC 4 SPEED - FWD

4T60E(M13), 4T65E(MN3, M15, MN7 H.D., M76)

ILL.	DESCRIPTION	QTY.	YEAR	PART NO.	REFERENCE NO.
DIFFERENTIAL SECTION (Cont.)					
618J	Sun Gear, Final Drive 30 T (Right Angled Teeth)	1	91-95	84618B	51955B
618J	Sun Gear, Final Drive 34 T (Left Angled Teeth).....	1	91-Up	84618AA	N/A
618J	Sun Gear, Final Drive 34 T (Right Angled Teeth)	1	91-95	84618A	51955A
618J	Sun Gear, Final Drive 34 T (Right Angled Teeth)	1	96-99	84618C	N/A
618J	Sun Gear, Final Drive 38 T (Right Angled Teeth)	1	91-95	84618	51955
618J	Sun Gear, Final Drive 38 T (Right Angled Teeth)	1	96-99	84618CA	N/A
618J	Sun Gear, Final Drive 42 T (4T60E) (Fine Tooth Pitch)	1	91-95	84618E	N/A
618J	Sun Gear, Final Drive 42 T (4T60E) (Fine Tooth Pitch)	1	96-99	84618CB	N/A
618J	Sun Gear, Final Drive 42 T (4T65E) (Fine Tooth Pitch)	1	97-Up	84618E	N/A
477	Reluctor, Final Drive Carrier (30 T)	1	91-Up	84477	66988A
477	Reluctor, Final Drive Carrier (31 T)	1	91-Up	84477A	66988C
477	Reluctor, Input (3 Mounts to Drive Sprocket) (25 T)	1	91-Up	84477B	66989
717	Washer, Differential Side Gear.....	1	83-92	84717-1	66418A
VALVE BODIES					
740A	Valve Body (Premium) (4T60E)	1	91-92	84740-4	P66991E
740A	Valve Body (Premium) (4T60E)	1	93-99	84740-1	P66991F
740A	Valve Body (Premium) (4T65E) (Holley Solenoid, 2 piece Pump Type) (Exc Volvo)	1	97-02	84740-2	P66991H
740A	Valve Body (Premium) (4T65E) (Holley Solenoid, 3 piece Pump Type) (Exc Volvo)	1	2002	84740-5	P66991K
740A	Valve Body (Premium) (4T65E) (Bosch Solenoid, 2 piece Pump Type) (Exc Volvo).....	1	2003	84740-6	P66991J
740A	Valve Body (Premium) (4T65E) (Bosch Solenoid, 3 piece Pump Type) (Exc Volvo).....	1	2003	84740-3	P66991L
740A	Valve Body (Premium) (4T65E) (Volvo)	1	99-02	84740-7	P66991V
740A	Valve Body (Premium) (4T65E) (Volvo & GM Tap Shift Type)	1	04-Up	84740-8	P84740-8
740A	Valve Body (Premium) (4T65E) (GM Non Tap Shift Type)	1	04-Up	84740-3	P66991L
VALVE BODY COMPONENTS					
741K	Boost Valve Kit, Modulated Line High Ratio (4T60E).....	1	91-99	84741MA-1	K66822D
741K	Boost Valve Kit, Modulated Line Low Ratio (4T60E).....	1	91-99	84741M-1	K66822C
741K	Boost Valve Kit, Reverse & Modulated Line (4T60E).....	1	91-99	84741MAK	K66822H
741K	Boost Valve Kit, Reverse & Modulated Line Low Ratio (4T60E)	1	91-99	84741MK	K66822L
741K	Boost Valve Kit, Reverse High Ratio (4T60E).....	1	91-99	84741RAK-1	K66822K
741K	Boost Valve Kit, Reverse Low Ratio (4T60E).....	1	91-99	84741RK-1	K66822J
741K	Boost Valve Kit (4T65E)	1	91-99	84741F	K66831
741K	E-Ring Retainer, Boost Sleeve (Bag of 10) (4T60E).....	1	91-99	84741-4G	66836
741K	Kit, 1-2 & Reverse Servo Boost Valve (4T60E) (requires T-84754-TL2)	1	91-99	84741GK	K66828
741K	Lock-Up Sleeve, Input & 3rd Clutch	1	91-99	84741C-2	66932
741K	Retainer Pin, Servo Boost Sleeve (Bag of 10) (4T60E)	1	91-99	84741-4A	66838
741K	Retainer, Boost Sleeve (Bag of 10) (4T60E)	1	91-99	84741-4B	66837
741K	Spring, Anti-Shutter (4T60E)	1	91-99	84741CE-3	N/A
741K	Sleeve, ISO Valve (requires T-84754-TL6).....	1	93-99	84741Q-1	66970S
741K	T.V. Plunger (.396" Steel) (4T60E)	1	91-99	84741NA-4	66971
741K	TCC Regulator & Isolator Valve Kit, PWM (requires T-84754-RM)	1	91-92	84741CAK	K66970A
741K	TCC Regulator Valve Kit (Eliminates Code 740).....	1	93-99	84741CK	K66970
741K	Valve Body Clip (Bag of 10) (4T60E)	1	91-99	84741-4F	66835
741K	Valve, 1-2 Shift (4T60E).....	1	91-99	84741SD-1	66823V
741K	Valve, 2-3 Shift (Anodized) (4T60E)	1	91-99	84741SB-1	66824V
741K	Valve, 3-2 Downshift (Anodized) (4T60E).....	1	91-99	84741S-1	66826V
741K	Valve, 3-4 Shift (Anodized) (4T60E)	1	91-99	84741SA-1	66825V
741K	Valve, 4-3 Downshift (Anodized) (4T60E)	1	91-99	84741SC-1	66827V
741K	Valve Kit, AFL Valve & Sleeve (4T65E) (requires T-F-84596-TL)	1	97-Up	84741LK	K66842
741K	Valve, TCC Apply O.S. (Codes 39, 740 & 1870) (4T60E) (requires T-84754-TL5 & -DJ2)	1	91-99	84741CC-1	66972BV
741K	Valve, TCC Apply O.S. (Codes 740 & 1870) (4T60E) (requires T-84754-TL).....	1	91-99	84741CA-1	66972V
741K	Valve, TCC Apply OEM (Codes 39, 740 & 1870) (4T60E)	1	91-99	84741CB-1	66972CV
741K	Valve, TCC Apply Standard (4T60E).....	1	91-99	84741C-1	66972AV
741K	Valve, TCC Apply w/ Teflon Seal (4T65E).....	1	97-Up	84741CD-1	K66833
741K	Valve Kit, TCC Regulated Apply (4T65E)	1	97-Up	84741QK	K66832

4T60E, 4T65E

4T60E(M13), 4T65E(MN3, M15, MN7 H.D., M76)

ELECTRONIC 4 SPEED - FWD

ILL.	DESCRIPTION	QTY.	YEAR	PART NO.	REFERENCE NO.
CHANNEL PLATES					
746E	Plate, Accumulator Cover to Case.....	1	91-99	84746A	N/A
755A	Channel Plate (4T60E) (Cast # Varies).....	1	91-92	84755H	66995E
755A	Channel Plate (4T60E) (Cast # 217) (No Switch).....	1	93-94	84755HA	66995F
755A	Channel Plate (4T60E) (Cast # 656) (Has Pan Bolt Studs).....	1	1994	84755JA	N/A
755A	Channel Plate (4T60E) (Cast # 656) (No Studs) (No TCC Piston).....	1	91-99	84755JE	N/A
755A	Channel Plate (4T60E) (Cast # 657) (No Studs) (No TCC Piston).....	1	91-99	84755JB	N/A
755A	Channel Plate (4T60E) (Cast # 657) (No Studs) (w/ TCC Piston).....	1	91-99	84755JC	N/A
755A	Channel Plate (4T60E) (Cast # 760).....	1	91-99	84755L	66995C
755A	Channel Plate (4T65E) (Cast # 479) w/ Axle Stabilizer Bore.....	1	97-Up	84755P	66995K
755A	Sleeve, Channel Plate (Presses In Channel Plate) (4T60E).....	1	91-99	84755S	66641
755A	Sleeve, Channel Plate (Presses In Channel Plate) (4T65E).....	1	97-Up	A84755SA	66641B
755A	Relief Valve, TCC Apply (Bag of 10) (4T65E).....	1	97-Up	84755A-1	66839
CASES & HOUSINGS					
760E	Case (4T60E) (Square Top Bell).....	1	91-99	84760C	N/A
760E	Case (4T60E) (Round Bell).....	1	91-99	84760CB	N/A
760E	Case (4T65E).....	1	97-Up	84760D	N/A
765K	Pan, Bottom (4T60E).....	1	91-99	84765A	N/A
765K	Pan, Bottom (4T65E).....	1	97-Up	84765B	N/A
766A	Pan, Side Cover (4T60E) (Aluminum) (w/ 4 Threaded Holes).....	1	91-99	84766B	N/A
766A	Pan, Side Cover (4T60E) (Aluminum) (w/ 6 Threaded Holes).....	1	91-99	84766BA	N/A
766K	Pan, Side Cover (4T65E).....	1	97-Up	84766C	66984
770E	Extension Housing (4T60E).....	1	91-99	84770	N/A
770E	Extension Housing (4T65E) w/ Bearing to Final Drive.....	1	97-Up	84770D	N/A
MISCELLANEOUS COMPONENTS					
683J	Pick-Up, Speed Sensor (29 T).....	1	97-Up	84683AC	N/A
683J	Pick-Up, Speed Sensor (30 T).....	1	91-Up	84683AA	66988A
683J	Pick-Up, Speed Sensor (31 T).....	1	91-Up	84683AB	66988C
686E	Cover (Electronic Speed-O Type) (4T60E).....	1	91-99	84686C	N/A
690J	Gear, Parking.....	1	91-Up	84690	66986
698D	Oil Dam, Front Planet.....	1	91-Up	84698	66910
699A	Weir, Oil Reservoir.....	1	91-Up	84699A	N/A
874	Snap Ring, Holds Pinion Pins In Differential Housing (Spiral).....	1	91-Up	76874A	53962S
895I	Snap Ring, Output Shaft to Differential.....	1	91-Up	84895	N/A
900K	Servo Assembly, Manual 2-1 (Forward).....	1	91-Up	84900	N/A
907E	Servo & Sleeve, 1-2 / Reverse.....	1	91-Up	84907AK	K66983
908E	Pin, 1-2 Servo (3.680") (4T60E).....	1	91-Up	84908H	66707F
909E	Cover, Forward Servo (4T60E).....	1	91-99	84909B	N/A
910E	Servo Assembly, Reverse (Cover is 3/4" Overall Thick) (4T65E).....	1	97-Up	84910G	N/A
912E	Piston, Reverse Servo.....	1	91-99	84912	N/A
914E	Cover, Reverse Servo (3 Bolt Type).....	1	91-99	84914A	N/A
926E	Spring, 1-2 Accumulator (Orange/Green).....	1	91-99	84926	66706
926E	Spring, 1-2 Accumulator (Plain Colored).....	1	91-99	84926B	N/A
927E	Piston, 1-2 Accumulator Deep Design (w/o Spring Recess) (Aluminum).....	1	91-99	84927	66993
927E	Piston, 1-2 Accumulator Deep Design (w/o Spring Recess) (Aluminum Replacement).....	1	91-99	A84927	N/A
927E	Piston, 1-2 Accumulator Deep Design (w/ Spring Recess) (Aluminum w/ O-Ring).....	1	97-99	84927C	66993B
927E	Piston, 1-2 Accumulator Deep Design (w/ Spring Recess) (Aluminum Replacement).....	1	97-Up	A84927D	6993K
927E	Piston, 1-2 Accumulator Shallow Design (Use 84927C) (4T60E).....	1	91-99	84927B	66993A
927E	Piston Kit, 1-2, 3-4 (2 Pistons, 1 Spring, 1 Spacer) Transgo (4T60E).....	1	91-99	A84927EK	K66993
928E	Pin, 1-2 & 2-3 Accumulator (4T60E).....	1	91-99	84928	66994
928E	Pin, 1-2 & 2-3 Accumulator (4T65E).....	1	97-Up	84928A	66994D
928E	Pin, Oversized Accumulator Allows Re-use of Worn Piston.....	1	91-99	84928X	66994P
928E	Pin & Reamer Kit, Includes OS Pin & Reamer for Boring Original Piston.....	1	91-99	84928XK	T-9149
929E	Cover, 1-2 & 2-3 Accumulator (Cast # 24203536) (4T65E).....	1	97-Up	84929G	N/A

ELECTRONIC 4 SPEED - FWD

4T60E(M13), 4T65E(MN3, M15, MN7 H.D., M76)

ILL.	DESCRIPTION	QTY.	YEAR	PART NO.	REFERENCE NO.
MISCELLANEOUS COMPONENTS (Cont.)					
934E	Accumulator Cover (4T60E)	1	91-99	84934B	N/A
934E	Accumulator Cover, w/ Tubes (Cast # 8651533) (4T60E)	1	91-99	84934A	N/A
934E	Accumulator Cover, w/ Tubes (Cast # 4X00317) (4T65E)	1	97-Up	84934G	N/A
935F	Accumulator Assembly, 3-4 (w/ 2" Tall Cover) (4T60E)	1	91-99	84935	N/A
935F	Accumulator Assembly, 3-4 (w/ 1 3/4" Tall Cover) (4T65E)	1	97-Up	84935G	N/A
936A	Spring, Middle Input For 3-4 Accumulator	1	91-Up	84936A	N/A
936A	Spring, Outer Input For 3-4 Accumulator	1	91-Up	84936B	N/A
936A	Spring, Inner Input For 3-4 Accumulator (Green/ Violet)	1	91-Up	84936C	N/A
936A	Spring, Inner Input For 3-4 Accumulator (Pink)	1	91-Up	84936R	N/A
936A	Spring, Inner Input For 2-3 Accumulator	1	91-99	84936RA	N/A
937A	Piston, 3-4 Accumulator Deep Design (w/o Spring Recess) (Aluminum)	1	91-99	84927	66993
937A	Piston, 3-4 Accumulator Deep Design (w/o Spring Recess) (Aluminum Replacement)	1	91-99	A84927	N/A
937A	Piston, 3-4 Accumulator Deep Design (w/ Spring Recess) (Aluminum w/ O-Ring).....	1	97-99	84927C	66993B
937A	Piston, 3-4 Accumulator Deep Design (w/ Spring Recess) (Aluminum Replacement) .	1	97-Up	A84927D	N/A
937A	Piston Kit, 3-4 (2 Pistons, 1 Spring, 1 Spacer) Transgo.....	1	91-99	A84927EK	K66993
937A	Piston, 3-4 Accumulator (Aluminum) (4T65E)	1	97-Up	D84937A	D66993K
937A	Piston, 3-4 Accumulator (Aluminum Replacement) (4T65E)	1	97-Up	A84927D	66993K
938A	Pin, Input or 3-4 Accumulator (1 3/4" Long).....	1	91-Up	84938	66994J
939F	Canister, 3-4 Accumulator Piston (2" Tall)	1	91-99	84939	N/A
941A	Spring, Converter Clutch Accumulator	1	91-99	84941	N/A
942A	Piston, Converter Clutch Accumulator	1	91-99	84942A	N/A
943A	Pin, Converter Clutch Accumulator.....	1	91-99	84943	N/A
961G	Piston, 4th Clutch (4T65E)	1	97-Up	84961	N/A
962B	Piston, 2nd Clutch Drum (Bonded) (5 1/8" OD) (4T60E).....	1	91-99	84962E	66929A
962B	Piston, 2nd Clutch Drum (5 3/8" OD) (Molded Rubber) (4T65E)	1	97-Up	84962G	66929B
964H	Piston, Input Clutch (8 Clutches on 3rd Clutch).....	1	91-Up	84964	N/A
964H	Piston, Input Clutch (10 Clutches on 3rd Clutch).....	1	91-Up	84964B	66934
965H	Piston, 3rd Clutch w/ Molded Rubber (w/ Check Ball) (4T60E).....	1	91-99	84965A	66917A
965H	Piston, 3rd Clutch w/ Molded Rubber (No Ck Ball) (4T65E).....	1	97-Up	84965G	66917B
971G	Springs w/ Retainer, 4th Clutch (3 3/8" ID) (4T60E).....	1	91-95	84971	66931
971G	Springs w/ Retainer, 4th Clutch (3 5/8" ID) (4T65E)	1	97-Up	84971G	N/A
972B	Spring w/ Retainer, 2nd Clutch (13/16" Tall) (4T60E)	1	91-99	84972B	66921A
972B	Spring w/ Retainer, 2nd Clutch (1 7/16" Tall) (4T65E)	1	97-Up	84972G	N/A
974H	Spring & Retainer, Input Clutch (16 Springs) (4T60E).....	1	91-95	84974	66923
974H	Spring & Retainer, Input Clutch (14 Springs) (4T65E).....	1	97-Up	84974G	N/A
975H	Guide w/ Spring Retainer, 3rd Clutch (12 Springs)	1	91-95	84975	66924
980	Spacer, 1-2 Sprag to Drum.....	1	91-99	84980	N/A
985H	Housing, 3rd Clutch (Takes Molded Piston) (No Check Ball) (4T60E)	1	91-95	84985A	N/A
985H	Housing,3rd Clutch (w/ Check Ball) (4T65E).....	1	97-Up	84985G	N/A
989	Retainer, Input Sprag Clutch (Late)	1	91-93	84989A	66925
991K	Rooster Comb Kit, w/ Link & Spring	1	91-99	84991E-3K	66957
992	Manual Shaft, Goes Thru Case	1	91-99	84992B	N/A
994	Park Rod.....	1	91-Up	84994C	N/A
996	Cooler Line Fitting (w/ Check Ball) (Flared)	1	91-99	84996AA	96-440
996	Cooler Line Fitting (w/ Check Ball) (Push In)	1	00-Up	74996A	96-440B
996	Connector, Cooler Line to Case (1 Req.) (4T65E).....	1	00-Up	74996B	96-460
999K	Retainer, Differential Lube Tube.....	1	91-Up	84999-5	66890

4T60E, 4T65E